

# - Positive Steering Mechanism -

## User Instructions

### 1. Hooking up

- ✓ Hook up to trailer as usual
- ✓ Use Latching mechanism to change the length to attach spoon to ball



- ✓ Be sure spoon is attached correctly by pulling the pin and pressing the button at the side.

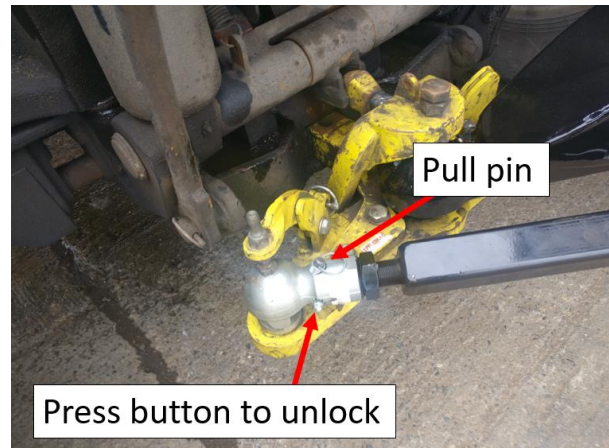

- ✓ Turn tractor & trailer slowly so latching mechanism lever pops back in as shown

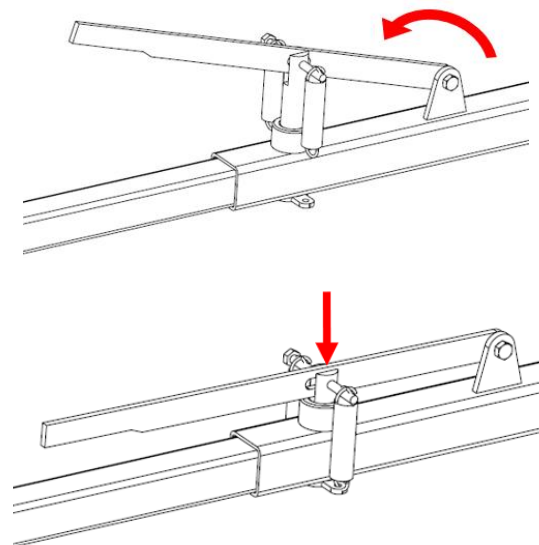

## 2. Tracking

Occasionally the steering mechanism will need to be tracked to ensure optimal performance. If the wheels appear to not be pulling in a straight line, follow instructions below

- ✓ Open **valves 1 – 5** as shown
  - > Turn anticlockwise to open
- ✓ Allow pressure drop to 0.

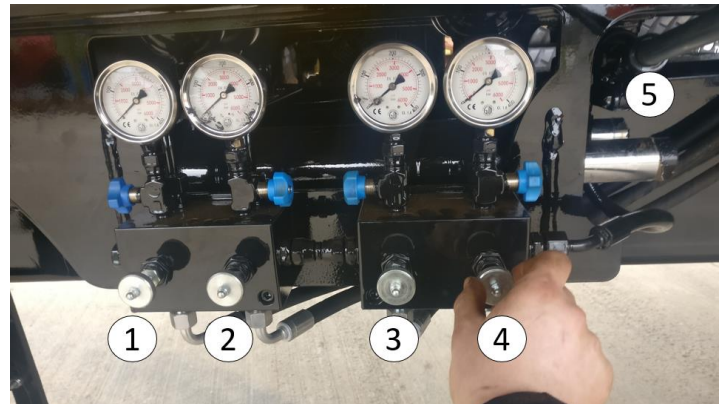

- ✓ Pull tractor and trailer in a straight line
- ✓ Drive until tractor, trailer & axles are in straight forward position



- ✓ Close **valve 5** (located on pump)
- ✓ Pump until pressure in each gauge reaches **at least 80 bar**.
  - > This may take a few minutes



- ✓ Close **valves 1-4** by turning clockwise
  - > Valves should be more difficult to turn with higher pressure.
- ✓ Trailer is now fully operational



### 3. Maintenance

<p><b>Checking oil</b></p>	<ul style="list-style-type: none"> <li>✓ Unscrew cap from hydraulic tank</li> <li>✓ Check oil on dipstick</li> <li>✓ Tank should be at least ½ full</li> </ul>	
<p><b>Greasing</b></p>	<ul style="list-style-type: none"> <li>✓ There is one grease point on the steering mechanism.</li> <li>✓ This is located at the hinge point of the 'swinging arm'</li> <li>✓ Steering axles should also be greased regularly</li> </ul>	
<p><b>Lubrication</b></p>	<ul style="list-style-type: none"> <li>✓ Use lubrication oil on latching mechanism for ease of use</li> </ul>	

If you have any issues please contact [sales@distag.com](mailto:sales@distag.com)